

DOOR DETAIL	
1	34" EXTERIOR DOOR
2	60" SLIDING EXTERIOR DOOR
3	48" CLOSET DOOR
4	30" DOOR
5	96" CLOSET DOOR
6	30" DOOR
7	30" DOOR
8	30" DOOR
9	60" CLOSET DOOR
10	60" CLOSET DOOR

Window Detail	
a	96" x 66" H WINDOW
b	57" x 37" H WINDOW
c	33" x 64" H WINDOW
d	33" x 64" H WINDOW
e	33" x 84" H WINDOW
f	45" x 21" H WINDOW

- Notes:**
1. ALL STRUCTURE, WINDOWS, DOORS, PLUMBING AND CLOSETS ARE EXISTING AND WILL NOT BE MODIFIED
 2. CEILING HEIGHT: 2438.4 mm
 3. EXTERIOR WALLS ARE EXISTING CONSTRUCTION, INSULATION IS PER HOUSE CONSTRUCTION CODE EFFECTIVE DATE
 4. CEILING INSULATION IS CONSISTENT WITH 1975 CONSTRUCTION. CEILING INSULATION IS UNCHANGED
 5. WINDOWS ARE AS PER ORIGINAL CONSTRUCTION AND ARE UNCHANGED.

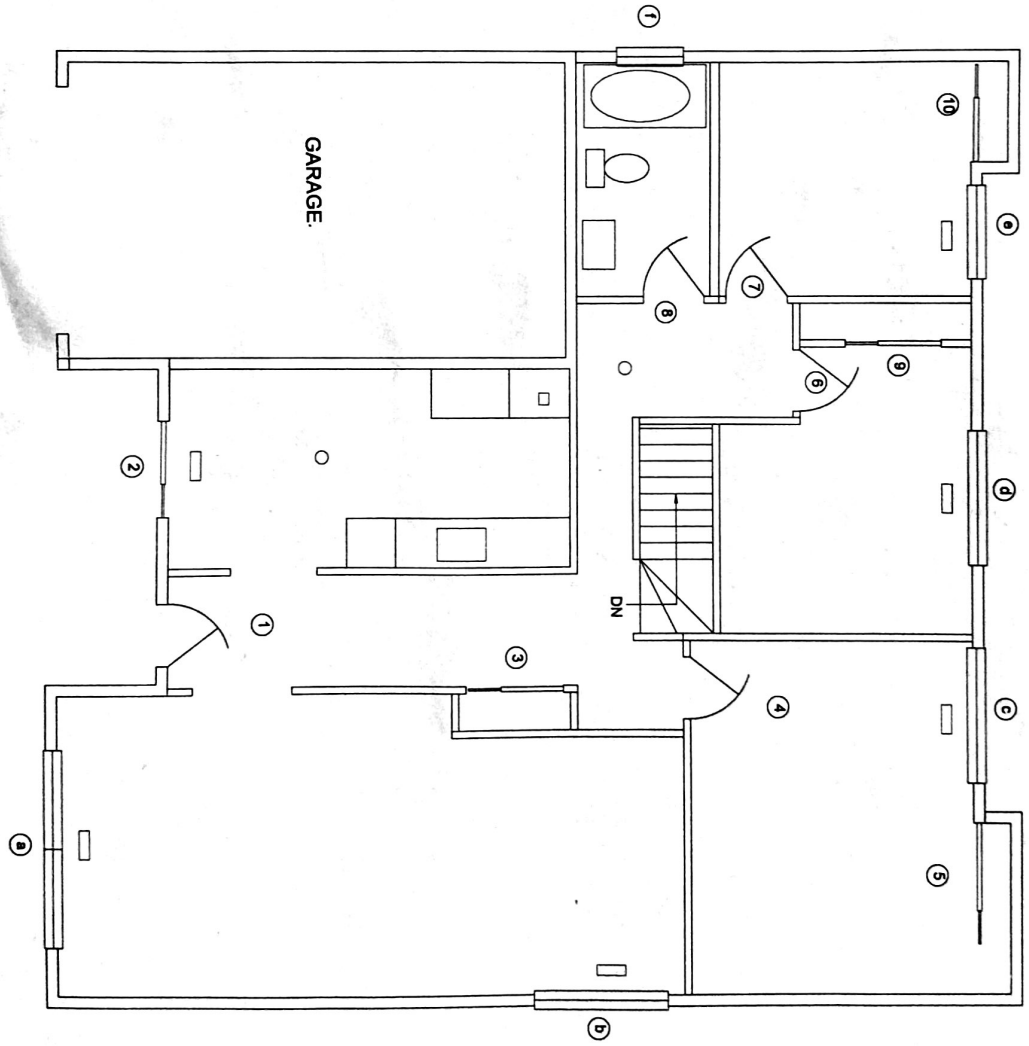

Project	Quantity	Unit/Volume	Approved by	Date	Project No./Reference
1168 CHERRYDOWN	N/A		N/A	04/16/17	1168
Client/Advertiser	N/A		Approved by	Date	
N/A			N/A		

DOOR DETAIL	
1	72" EXTERIOR SLIDING DOOR
2	30" DOOR
3	30" DOOR
4	60" CLOSET DOOR
5	30" DOOR

Window Detail	
a	16" x 36" WINDOW
b	36" x 54" WINDOW
c	36" x 54" WINDOW
d	16" x 36" WINDOW
e	16" x 36" WINDOW

- Notes:**
1. ALL STRUCTURE, WINDOWS, DOORS, PLUMBING AND CLOSETS ARE EXISTING AND WILL NOT BE MODIFIED
 2. CEILING HEIGHT: 2438.4 mm
 3. EXTERIOR WALLS ARE EXISTING CONSTRUCTION, INSULATION IS PER HOUSE CONSTRUCTION CODE
 4. CEILING INSULATION IS CONSISTENT WITH 1975 CONSTRUCTION, CEILING INSULATION IS UNCHANGED
 5. WINDOWS ARE AS PER ORIGINAL CONSTRUCTION AND ARE UNCHANGED.

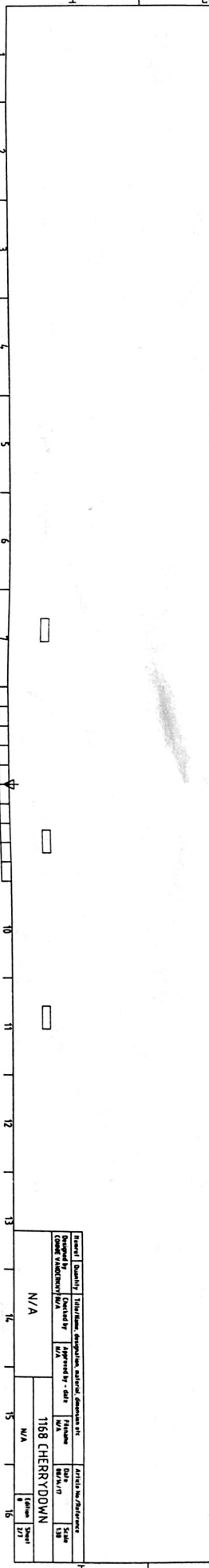
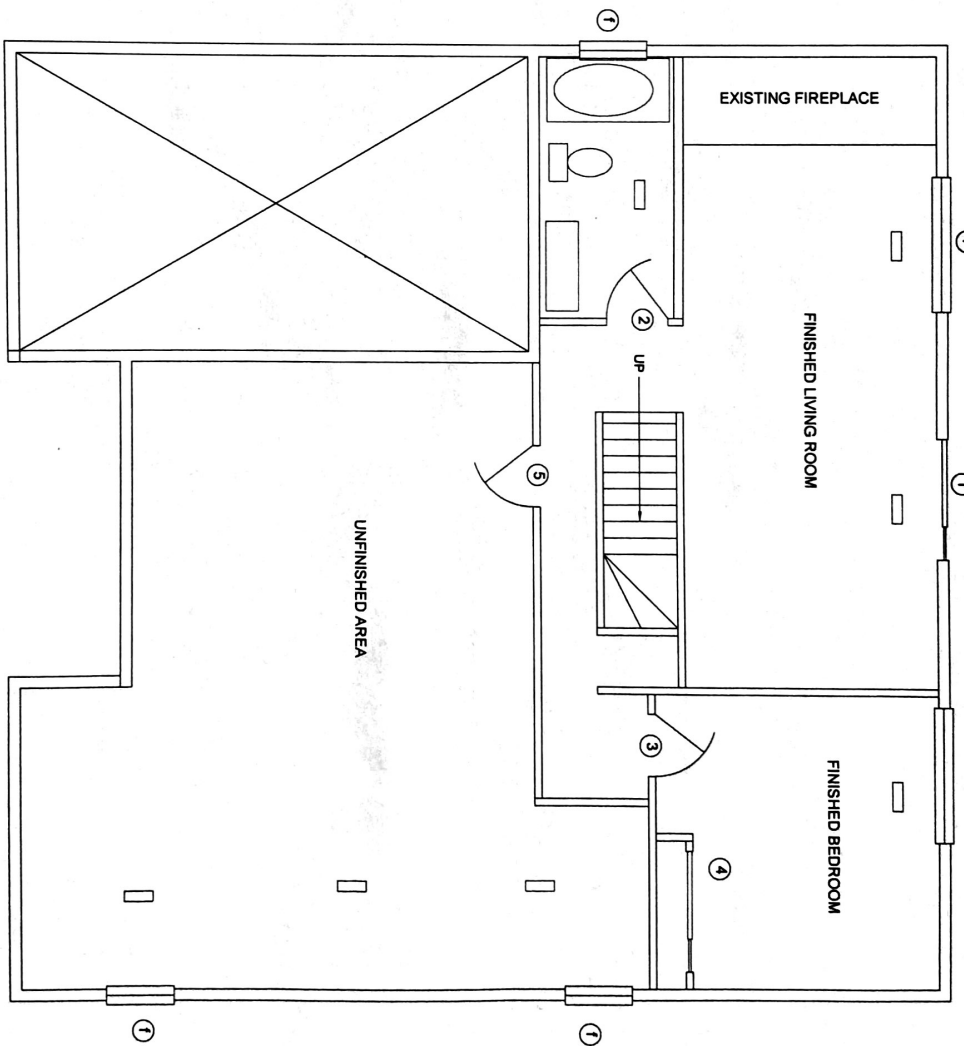

Item #	Quantity	Description	Unit	Notes
1	N/A	1688 CHERRYDOWN	sqm	
2	N/A		sqm	

DOOR DETAIL

1	72" EXTERIOR DOOR
2	28" CLOSET DOOR
3	30" DOOR
4	30" DOOR
5	60" CLOSET DOOR
6	30" DOOR
7	60" CLOSET DOOR
8	30" DOOR

Window Detail	
a	16" x 36" WINDOW
b	36" x 54" WINDOW
c	36" x 54" WINDOW
d	36" x 36" WINDOW (THIS WINDOW IS NEW CONSTRUCTION)
e	16" x 36" WINDOW

Notes:

- HOOD RANGE OVER STOVE EXHAUSTED TO OUTSIDE
- DRYER EXHAUST VENTED TO OUTSIDE
- BATHROOM TO BE CHANGE TO ALLOW FOR A TUB INSTEAD OF A SHOWER
- BATHROOM VENT TO BE INSTALLED, EXHAUSTED TO OUTSIDE.
- FINISHED CEILING HEIGHT NOT UNDER BULKHEAD IS 2219.3 mm

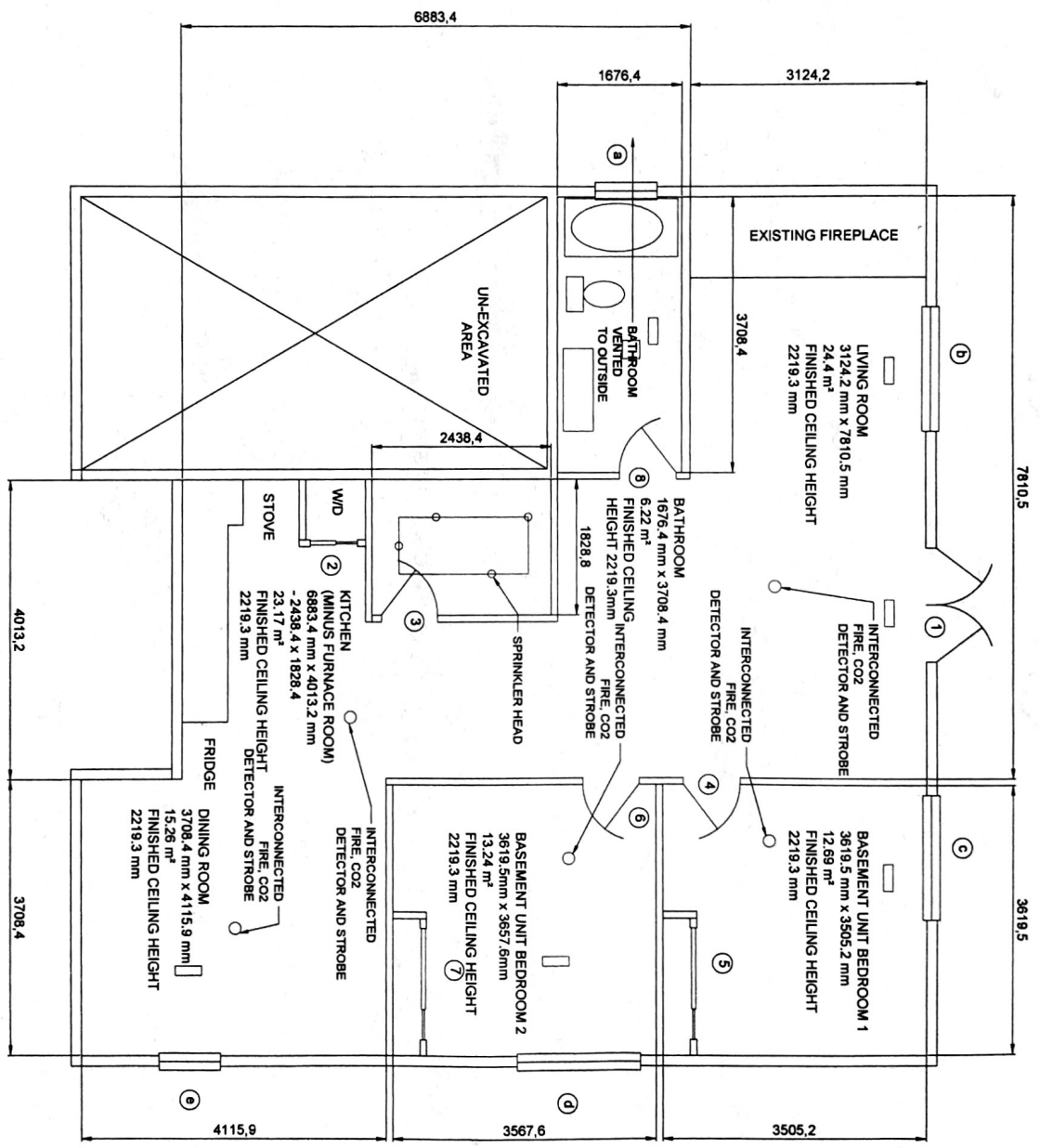

Item	Quantity	Unit	Description	Material	Notes
1	N/A		1168 CHERRYDOWN BASEMENT		

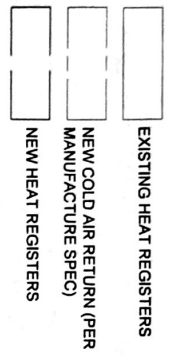

LIGHT SWITCH



Notes:

1. CEILING HEIGHT: 2286 mm
2. HOOD RANGE OVER STOVE EXHAUSTED TO OUTSIDE
3. DRYER EXHAUST VENTED TO OUTSIDE
4. BATHROOM TO BE CHANGE TO ALLOW FOR A TUB INSTEAD OF A SHOWER.
5. BATHROOM VENT TO BE INSTALLED, EXHAUSTED TO OUTSIDE
6. WALLS CLOSING IN STRUCTURAL STEEL MEMBERS WILL BE COVERED WITH 1/2" TYPE X DRYWALL TO PROTECT STEEL BEAMS AND SUPPORT POSTS. FIRE RESISTANCE RATING TO BE 60 MINUTES.
7. WALLS TO BE CONSTRUCTED OF 2X4 LUMBER.
8. EXISTING WALLS AS DETAILD. ALL OTHER WALLS TO BE CONSTRUCTED OF 2X4 MATERIAL COVERS WITH 1/2" DRYWALL.
9. KITCHEN WALLS TO BE CONSTRUCTED WITH 2X6 LUMBER COVERED WITH 1/2" DRYWALL.
10. IN DUCT SMOKE DETECTOR TO BE INSTALLED IN FURNACE TO SHUT OFF FURNACE IN CASE OF SMOKE/FIRE

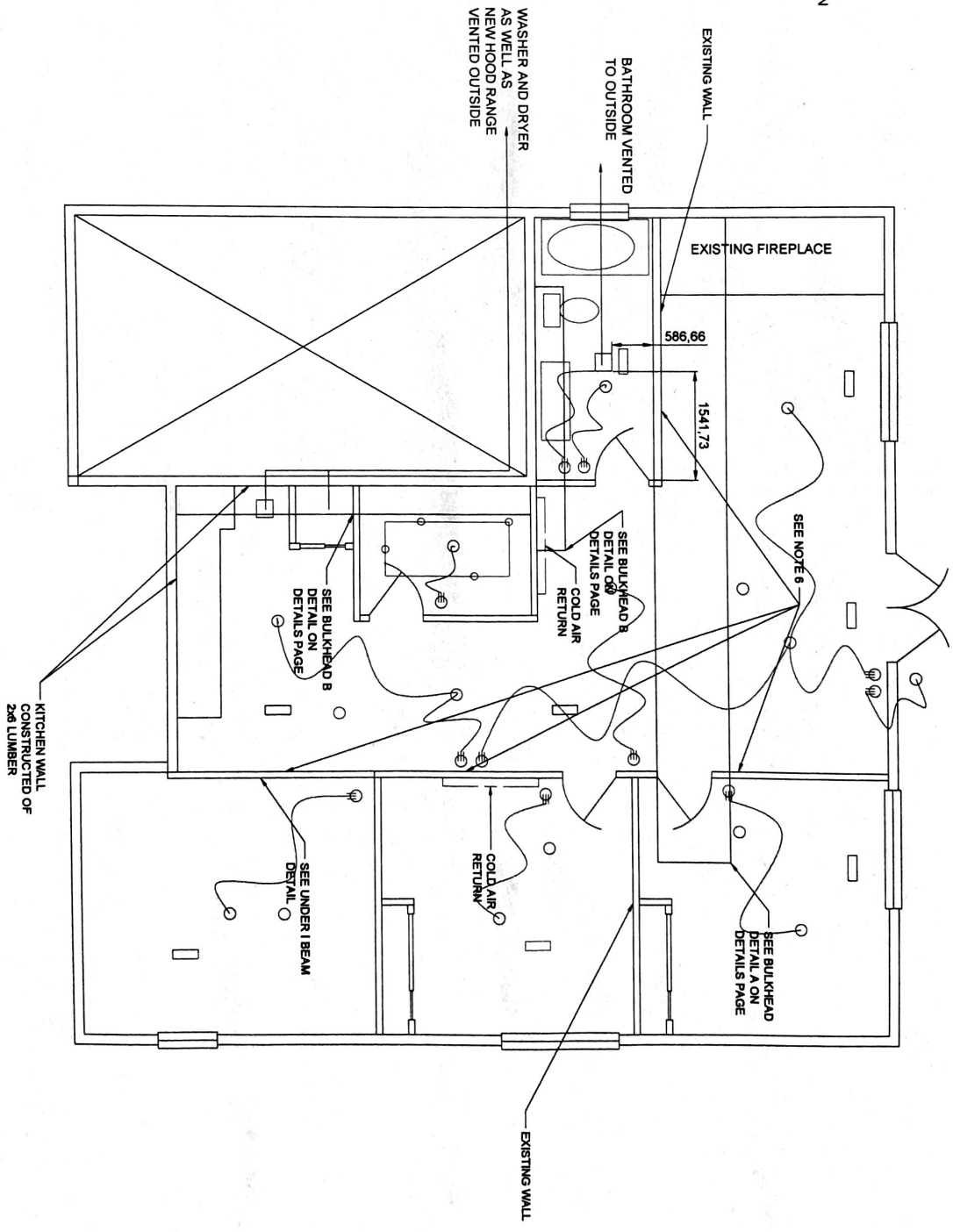

Item	Quantity	Trade/Item Description, Material, Dimensions, etc.	Unit	Notes
1		1168 CHERRYDOWN		
2				
3				
4				
5				
6				
7				
8				
9				
10				
11				
12				
13				
14				
15				
16				

